

6301/177-219 Mitchell Road Erskineville NSW

1 1 1

Nestled amid the oasis-like gardens of Sydney Park Village, this one bedroom apartment features an open plan layout with light filled aspect and recently renovated interiors. Sitting on the fringe of Sydney's inner west and inner city, its popular location is 5km from the CBD, 5 minute walk to St Peters station & 10 minute walk to Erskineville station. Highly prized for its relaxed yet vibrant community feel and only moments to Newtown's enduring pub culture and buzzing café scene, Sydney Park Village is arguably one of the most sought after resort style buildings in Sydney. Offering incomparable facilities including 24 hour security, 60 visitor car spaces, outdoor pools, tennis courts, upgraded gymnasium, indoor heated lap pool, onsite café, onsite building management, beautician & more - plunge into this urban sanctuary.

Price : \$700 pw

View : <https://www.agentsandco.com.au/lease/nsw/inner-west/erskineville/residential/apartment/8079684>

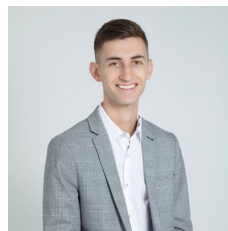

Anthony Schembri
02 9314 2100



Eleni Roumanous
02 9314 2100

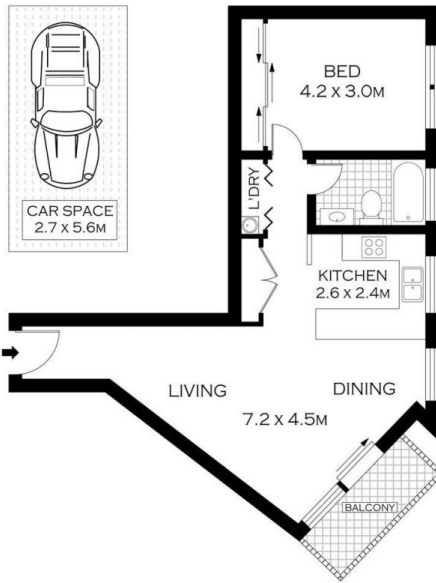

LEVEL THREE



PLANS SHOWN ONLY INDICATIVE OF LAYOUT. DIMENSIONS ARE APPROXIMATE.
Floor plans by www.realestatemarketingaustralia.com.au
Ref. No. 2282

6301/177-219 MITCHELL ROAD

ERSKINEVILLE