



## 2 Dewsbury Street Botany NSW

4 2 2

### The Lifestyle:

Set on a quiet tree lined street in a sought-after pocket of Botany, this freestanding two storey family home offers spacious sun washed interiors with open plan living and flexible accommodation options. It's footsteps from Sir Joseph Banks Park and Son of a Baker Cafe.

### Property Features Include:

- + Generous living/dining area flows to outdoor entertaining
- + North facing easy-care garden, kids cubby house & fish pond
- + Modern family sized gas kitchen w/stainless steel appliance
- + Four large bedrooms w/built-ins/wir, study/office with CCTV
- + Well-presented main bathroom

**Land Size** : 328 sqm

**View** : <https://www.agentsandco.com.au/lease/nsw/eastern-suburbs/botany/residential/house/7667696>



**Eleni Roumanous**  
02 9314 2100

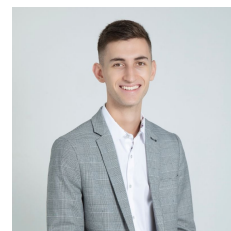

**Anthony Schembri**  
02 9314 2100

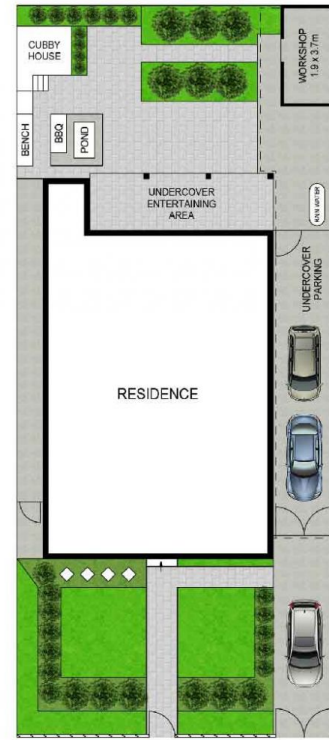
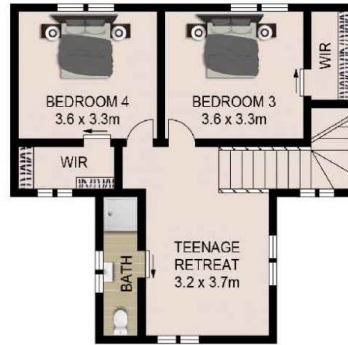

All information contained herein is gathered from sources we deem to be reliable.  
However we cannot guarantee its accuracy and interested parties should rely on their own enquiries.  
Ref. No: 87072

2 DEWSBURY STREET

BOTANY

