



10 Hunter Avenue Matraville NSW

3 2 4

The Lifestyle;

Impressive family home on huge land with north aspect. On a sprawling level 658sqm block, this warm and welcoming family home takes full advantage of its prized northern aspect and tranquil garden setting. With immaculate interiors and a beautiful sense of space it is set in a convenient position only metres to Barwon Park and minutes to beaches, shopping and local schools.

Property Features Include;

- Free flowing layout with living and dining area with high vaulted ceiling
- Family sized open plan kitchen with gas appliances and breakfast bar

[For full version visit the website](https://www.agentsandco.com.au/lease/nsw/eastern-suburbs/matraville/residential/house/7414859)

Type : House
Land Size : 658 sqm
View : <https://www.agentsandco.com.au/lease/nsw/eastern-suburbs/matraville/residential/house/7414859>



Eleni Roumanous
02 9314 2100

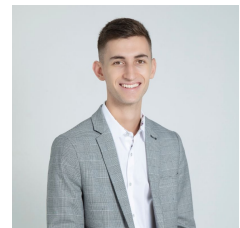

Anthony Schembri
02 9314 2100

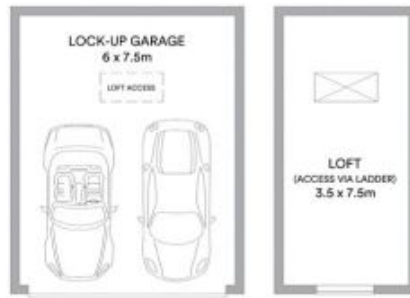
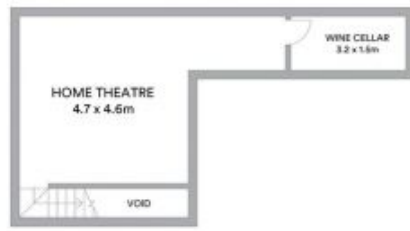

Internal 182sqm