



4/10A Daphne Street BOTANY NSW

4 2 2

Positioned in one of Botany's best locations and only 500 metres to an array of cafes, parks and transport, this three level terrace will impress you from the moment you walk in.

View : <https://www.agentsandco.com.au/sale/nsw/easter-n-suburbs/botany/residential/townhouse/6767669>

About The Home;

- 4 bedrooms, main with en-suite and walk in robes
- Spacious and light filled living and dining areas
- Pet friendly backyard with beautiful outdoor entertaining area
- 2 double lock up parking and storage rooms
- Spacious kitchen with gas cooking

The Lifestyle;

The bayside suburb of Botany enjoys an enviable location just 11kms south of Sydney CBD and set within close proximity to picturesque Little Bay, La Perouse, Maroubra



Nick Papas
02 9314 2100

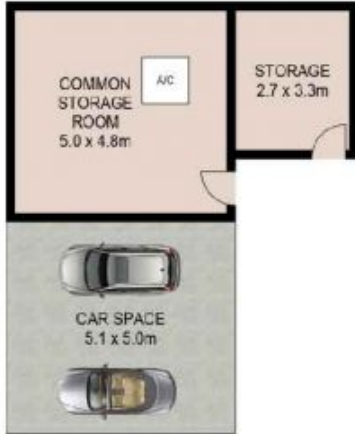

SECOND FLOOR

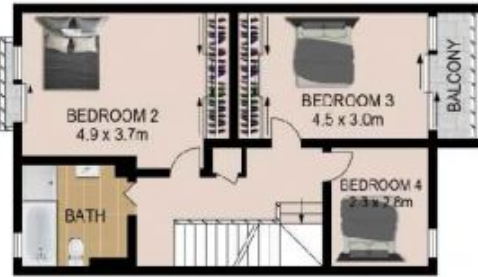

FIRST FLOOR



GROUND FLOOR



PLANS SHOWN ONLY INDICATIVE OF LAYOUT. DIMENSIONS ARE APPROXIMATE.
Ref No: B5672



4/10A DAPHNE STREET

BOTANY