



8 Ermington Street BOTANY NSW

5 3 2

One of Botany's finest homes, this contemporary residence impresses with its palatial interiors and luxurious finishes. This family home offers stylish, low maintenance interiors with a multitude of living space. It holds a tranquil position a stroll from parks and cafes, easy access to Sydney CBD while Westfield Eastgardens is only minutes away.

View : <https://www.agentsandco.com.au/sale/nsw/eastern-suburbs/botany/residential/house/6767565>

Features:

- Spacious open plan living dining area, plus separate living at the front of the home
- Gourmet kitchen with mirror splash back, breakfast bar, stainless steel appliances
- Glass staircase leads to upper level boasting four bedrooms with built in wardrobes
- Secluded master suite with large walk in wardrobe, plush carpet, luxurious ensuite



GROUND FLOOR

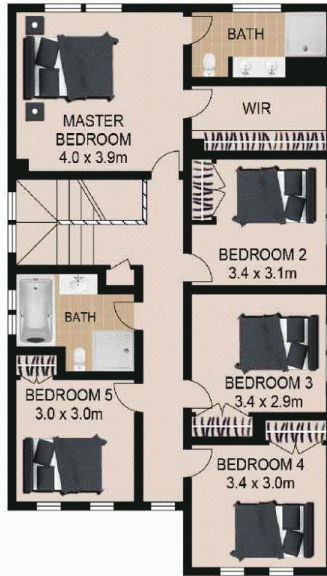

FIRST FLOOR



SITE PLAN
(NOT TO SCALE)

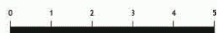

SCALE (METRES)

PLANS SHOWN ONLY INDICATIVE OF LAYOUT. DIMENSIONS ARE APPROXIMATE.
Ref. No: 71146

8 ERMINGTON STREET



BOTANY