



51 Storey Street MAROUBRA NSW

2 1 1

Conveniently placed in one of Maroubra's finest streets bordering Kingsford, this classic attached residence presents an exceptional opportunity to buy and create your own masterpiece. Being offered for the first time in over 40 years opportunities like this are rare and not to be missed.

Land Size : 289 sqm
View : <https://www.agentsandco.com.au/sale/nsw/eastern-suburbs/maroubra/residential/house/6767502>

Features include:

- Spacious interiors with separate lounge and dining area
- Great North facing aspect
- Original neat & tidy fixtures & fittings
- Sunny low maintenance garden
- Potential to extend or add a second level
- Peaceful & Tranquil location, moments to parks, schools, shops, transport & off-street parking
- Walking distance to all major amenities include Pacific Square & Westfield Eastgardens



Nick Papas
02 9314 2100

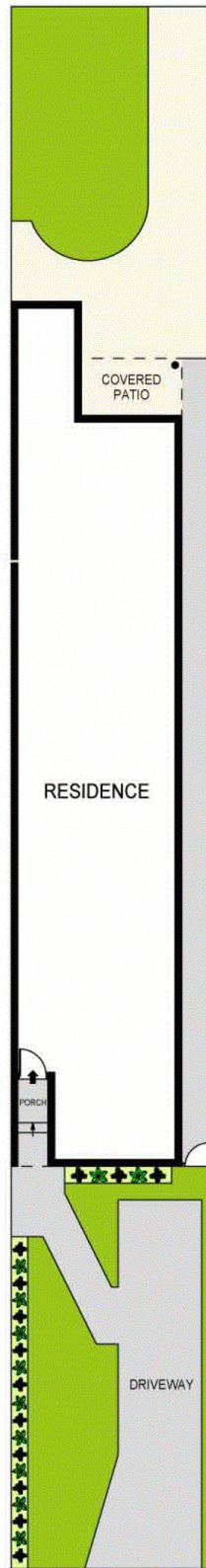
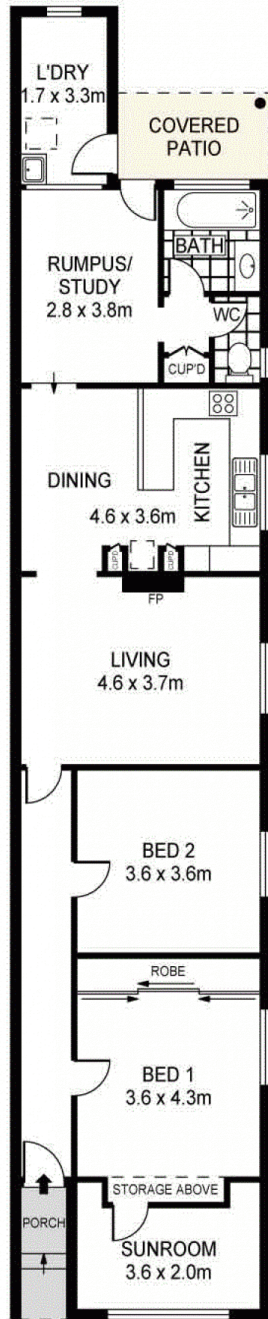

SITE PLAN
(NOT TO SCALE)



SCALE (METRES)

ALL INFORMATION CONTAINED HEREIN IS GATHERED FROM SOURCES WE DEEM TO BE RELIABLE. HOWEVER WE CANNOT GUARANTEE ITS ACCURACY AND INTERESTED PARTIES SHOULD RELY ON THEIR OWN ENQUIRIES. REF. NO: 60000



51 STOREY STREET

MAROUBRA