



33 Trevelyan Street Botany NSW

4 2 3

About The Home;

- Four generous sized bedrooms
- Two/Three separate living areas
- Designer kitchen with breakfast bar
- Sundrenched balcony overlooking the backyard with district views
- 2kw Interactive solar system with off the grid batteries
- Side driveway passage accessing backyard
- Undercovering parking with additional ease of garage or granny flat addition (STCA)
- Sprawling 601sqm block, 15.24m frontage
- Massive development potential (STCA)

Type : House
Land Size : 601 sqm
View : <https://www.agentsandco.com.au/sale/nsw/eastern-suburbs/botany/residential/house/6764165>



Clay Chigwidden
02 9314 2100

[For full version visit the website](https://www.agentsandco.com.au)

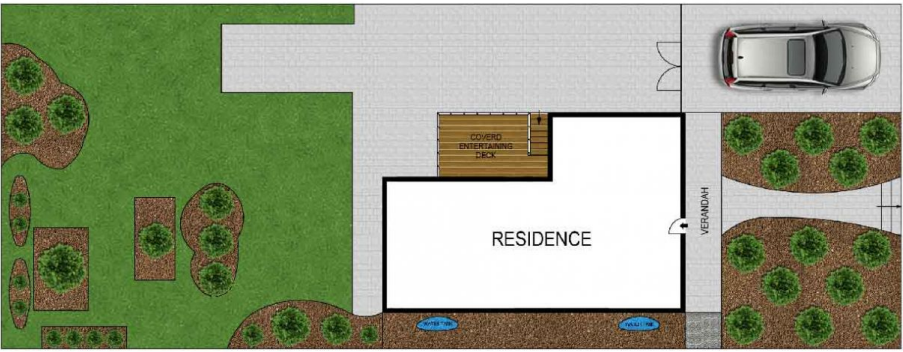

SITE PLAN
(NOT TO SCALE)



GROUND FLOOR



FIRST FLOOR

0 1 2 3 4 5
SCALE (METRES)

All information contained herein is gathered from sources we deem to be reliable.
However we cannot guarantee its accuracy and interested parties should rely on their own enquiries.
Ref. No. 22866



33 TREVELYAN STREET

BOTANY