



52 Kingsland Road BEXLEY NSW

3 3 4

Surrounded by lush tropical greenery, in a quiet cul-de-sac street, this bright and airy home captures the essence of relaxed family living.

View : <https://www.agentsandco.com.au/lease/nsw/st-george/bexley/residential/house/6745363>

- * Tri-level, including basement garage with internal access
- * Three generously-sized bedrooms, all with built-in wardrobes
- * Main bathroom with separate shower and spa bath
- * En-suite bathroom plus guest toilet just off living room
- * Stone gourmet kitchen, equipped with dishwasher and gas cooking
- * Enormous separate living and dining area, tiled throughout
- * Ducted air-conditioning throughout all levels
- * Courtyard perfect for entertaining plus low maintenance grass for kids play



Maddison Christie
02 9314 2100

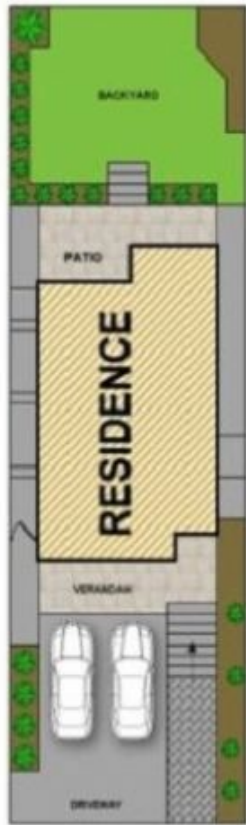

SITE PLAN (not to scale)

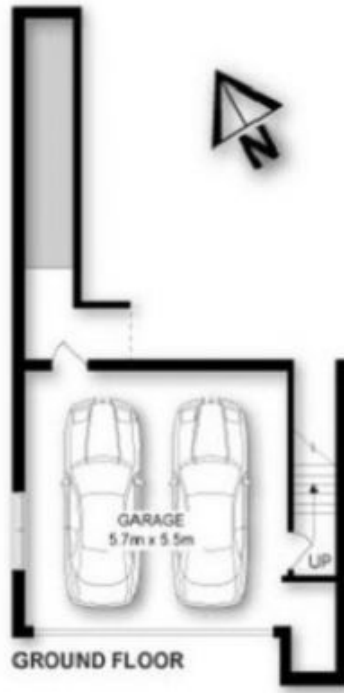

GROUND FLOOR



MAIN FIRST FLOOR

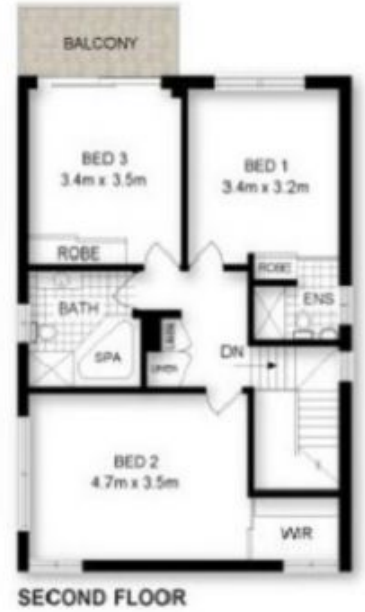

SECOND FLOOR



DISCLAIMER: THIS IS FOR ILLUSTRATIVE PURPOSES ONLY. ALL DIMENSIONS ARE APPROXIMATE AND IT DOES NOT CONSTITUTE PART OF ANY LEGAL DOCUMENTS.

ADDRESS:

52 KINGSLAND ROAD SOUTH, BEXLEY